



SFS Flow Module



Thermal mass flow module



For fast, continuous gas flow monitoring



Benefits & characteristics



- Fast, continuous gas flow monitoring with ≤ 20 ms response time



- Ready-to-use module with digital and analog outputs



- Compact design for easy integration into measuring devices - integration space 5x4x2 cm sufficient



- Factory calibrated in sccm (ml/min) with 0.2% reproducibility

- Direction independent calorimetric measurement

- Hardware address pins for systems with up to 4 modules

Custom, application specific adaptation possible



Evaluation kit with fluidic adapter block

Fluidic adapter block in aluminum with M5 threads. Supplied with connectors for OD 4 mm tubing.



SFS Flow module front

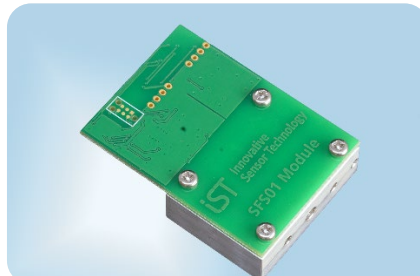

SFS Flow module rear



Evaluation kit with fluidic adapter block rear view

Applications

- Gas analyzers
- Gas supply and dosing systems
- Gas mixing valves
- Process control
- Medical devices
- Environmental monitoring and analytical equipment



Sensor performance



Available modules



Module type	Bidirectional flow range*	Unit	Material number
-------------	---------------------------	------	-----------------

SFS01-M-01-01000	±1000	sccm	154807
------------------	-------	------	--------

SFS01-M-01-00200	±200	sccm	154808
------------------	------	------	--------

SFS01-M-01-00050	±50	sccm	154809
------------------	-----	------	--------

* calibrated for N₂ at 23 °C (sccm ~ ml/min)

Flow parameters*

Accuracy	±2 % f.s.	digital output
	±5 % f.s.	analog output

Repeatability	±0.2 % f.s.
---------------	-------------

Response time t ₆₃	20 ms
-------------------------------	-------

Temperature Sensitivity**	0.3 % / K
---------------------------	-----------

* for N₂

** signal not temperature compensated

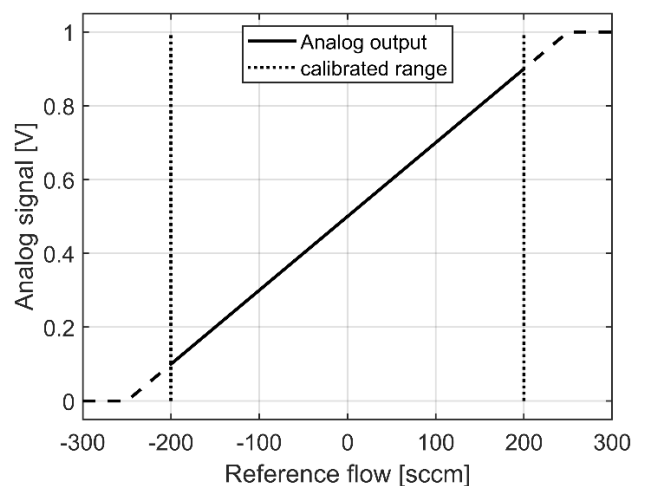
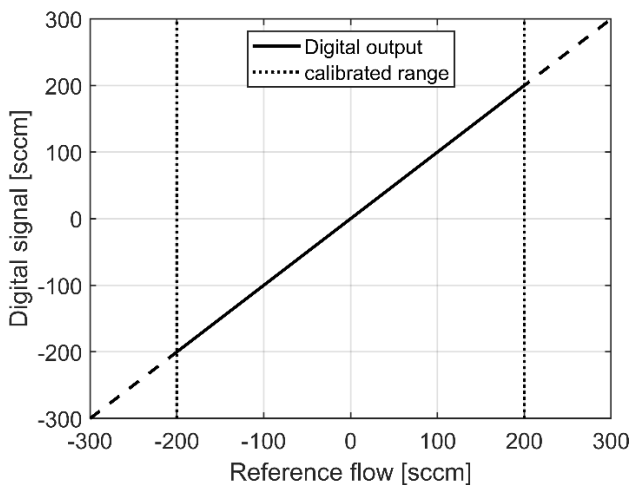

Digital and analog output as a function of flow (displayed 200 sccm module variant as example).



Operational conditions



Gas temperature 0 to +80 °C



Pressure < 4 bar



Humidity 0 to 95 % RH (non-condensing conditions required)



Storage temperature -20 to +80 °C



Recommended warm-up time (electronics) 30 s



Pressure loss



Module type **Pressure loss***

SFS01-M-01-01000 < 1 mbar

SFS01-M-01-00200 < 1 mbar

SFS01-M-01-00050 < 6 mbar

* operated at maximum flowrate with N₂ at 23 °C

Electrical parameters

Supply voltage 5V DC ±10%

Sampling rate > 100 Hz

Power Consumption < 10 mA at 5V VCC

Electrical Connector JST SM08B-SRSS-TB

A 200 mm cable assembly with a compatible connector is available at DigiKey with part no. 455-3658-ND

Digital output

Communication Protocol I²C

I²C clock frequency 10 ... 400 kHz (Typical 100kHz)

I²C default address 0x28 (see section address pins, only 7 bit addresses supported)

Digital output (calibrated signal) calibrated flow rate sccm (signed integer - 16 bit)



50 sccm	fixed point	(Q7 decoding)
---------	-------------	---------------



200 sccm	fixed point	(Q5 decoding)
----------	-------------	---------------



1000 sccm	fixed point	(Q3 decoding)
-----------	-------------	---------------



Analog output

Analog signal	0-1 V	(0.1V at calibration range minimum, 0.5V at zero flow, 0.9 V at calibration range maximum)
---------------	-------	--



Resistive load	>100kΩ	(The output is protected by a 1kΩ series resistor)
----------------	--------	--



Pin Assignment

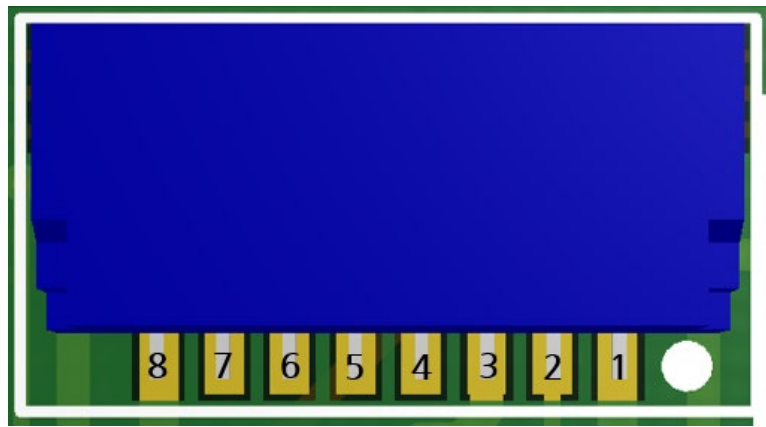

1	2	3	4
SCL (I ² C serial clock)	SDA (I ² C serial data)	VCC (positive voltage supply)	GND (ground)
5	6	7	8
Addr0 (Address Pin 0*)	Addr1 (Address Pin 1*)	Analog output	GND (Ground)

* Leave open it if not used, connect to VCC to change the Serial Address

Digital Interface I²C Protocol

Reading data

After a power-on reset, the module waits for 1000ms before the measurement starts. After this time, sensor data is available and can be read out.

Sensor data can be read out by a simple read command and a consecutive read of 2 Bytes. The calibrated data are encoded as signed 16-bit integers.

S	6	5	4	3	2	1	0	R	A	7	6	5	4	3	2	1	0	A	7	6	5	4	3	2	1	0	NA	P
S	0	1	0	1	0	0	0	1	A	D	D	D	D	D	D	D	D	A	D	D	D	D	D	D	D	D	NA	P
Device Address (0x28)								Calibrated Data [15...8]								Calibrated Data [7...0]												



Signal flow for data readout (2 Bytes)



S	Start	A	Acknowledge
---	-------	---	-------------



R	Read	P	Stop
---	------	---	------



W	Write	D	Data
---	-------	---	------



NA	Not Acknowledge		
----	-----------------	--	--



	Signal generated by Device		Signal generated by Master
--	----------------------------	--	----------------------------



Decoding the data

The calibrated flow rates are represented in a signed fixed-point notation. For each version of the module a different coefficient is required to convert the digital value to the actual flow rate. See table below for examples.

The calibrated flow rates are represented in a signed fixed-point notation. For each version of the module a different coefficient is required to convert the digital value to the actual flow rate. See table below for examples.

Module	Digital value	Coefficient	Calculation example	Calculated Flow rate
50 sccm	4848 (0x12F0)	128	4848 / 128	37.875 sccm
200 sccm	4848 (0x12F0)	32	4848 / 32	151.5 sccm
1000 sccm	4848 (0x12F0)	9	4848 / 8	606 sccm
A negative value corresponds with opposite flow direction and is represented in a two's complement.				
50 sccm	-3240 (0xF358)	128	-3240 / 128	-25.3125 sccm
200 sccm	-3240 (0xF358)	32	-3240 / 32	-101.25 sccm
1000 sccm	-3240 (0xF358)	9	-3240 / 8	-405 sccm

I2C Address pins

Addressable pins as a hardware setting for simple manifold assemblies with up to 4 modules

Addr1	Addr0	Resulting Address (Hex)	Resulting Address (Bin)
Low	Low	0x28	0b0101000
Low	High	0x29	0b0101001
High	Low	0x2A	0b0101010
High	High	0x2B	0b0101011
Open	Open	0x28	0b0101000

To change the I2C address, the module needs to reboot. Either restart the module by a power cycle or send the command 0xA2 to the module.



Reset the module

S	6	5	4	3	2	1	0	W	A	7	6	5	4	3	2	1	0	A
S	0	1	0	1	0	0	0	0	A	1	0	1	0	0	0	1	0	A
Device Address (0x28)									Reset (0xA2)									



This reset command equals a power on reset. After a reset, the module is booting up and waits ~1000ms until the measurements start again.



Mechanical parameters (SFS module only, i.e. without fluidic block adapter)



Size	48 x 34 x 14.5 mm
Weight	30g
Flow channel	Aluminium
Wetted materials	Aluminium, gold, FR4, silicon, silicon nitride, epoxy, nitrile
Assembly recommendation	Flat sealing with two sealing rings; Ø 2.50 mm x 1.00 mm



Mechanical Dimensions

Dimensions tolerances according to ISO 2768-mK: +/-0.1mm up to 6 mm; +/-0.2 mm up to 30 mm

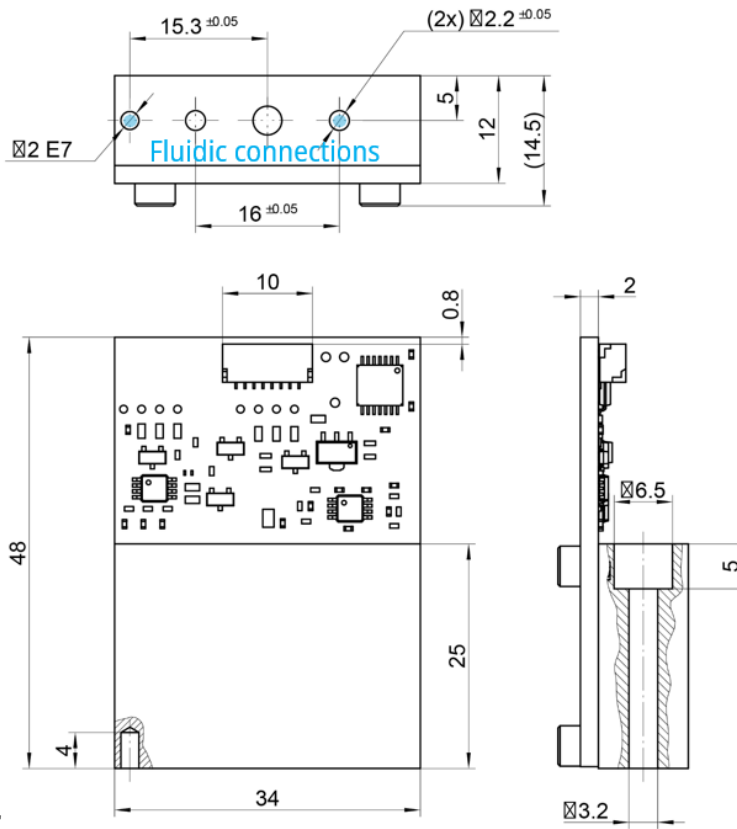

Fluidic Block adapter

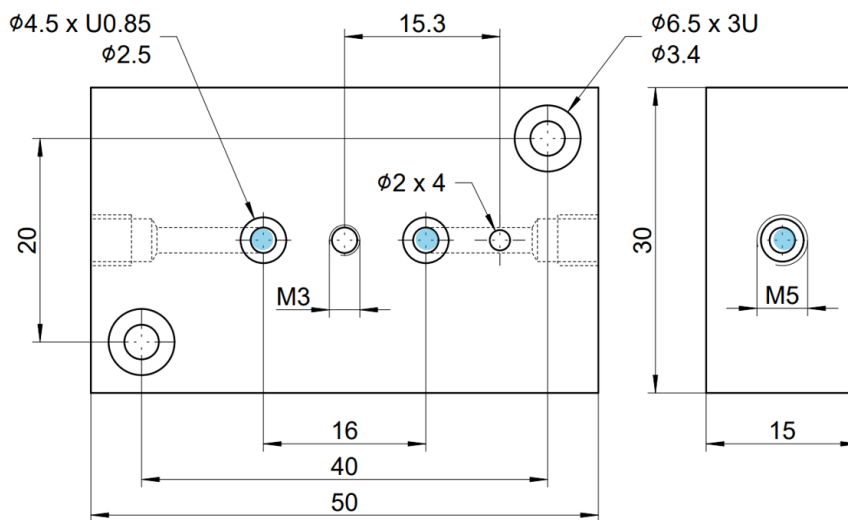

Fluidic adapter block in aluminum with M5 threads. Supplied with connectors for OD 4 mm tubing.

Please contact iST if you require a STEP file for product design-in



Order information



Product name	Description	Order code	Flow range
SFS01-M-01-01000	SFS Flow module	154807	±1000 sccm
SFS01-M-01-00200	SFS Flow module	154808	±200 sccm
SFS01-M-01-00050	SFS Flow module	154809	±50 sccm
Evaluation Kits:			
SFS01-M-01-01000-EVA	SFS01 Module Evaluation Kit	156602	±1000 sccm
SFS01-M-01-00200-EVA	SFS01 Module Evaluation Kit	156603	±200 sccm
SFS01-M-01-00050-EVA	SFS01 Module Evaluation Kit	156604	±50 sccm
Related Products			
SFS01	Flow Sensor Element	105050	
SFS01 EvaKit	EvaKit with 1x1 mm PEEK channel	105059	
SFS01-MFB-01	Fluidic adapter block, separate	155638	
FGF-E1-M-01-01000-EVA	Flow + density module	156393	±1000 sccm
FGF-E1-M-01-00200-EVA	Flow + density module	156601	±200 sccm

Additional Documents

	Document name:
Application Note SFS01	AHSFS01
Data sheet SFS01	DFSFS01_E
Data sheet SFS01 EvaKit	DFSFS01_EvaKit_E



Innovative Sensor Technology IST AG • Stegrütistrasse 14 • 9642 Ebnat-Kappel • Switzerland
+41 71 992 01 00 • info@ist-ag.com • www.ist-ag.com

All mechanical dimensions are valid at 25 °C ambient temperature, if not differently indicated • All data except the mechanical dimensions only have information purposes and are not to be understood as assured characteristics • Technical changes or product specifications without previous announcement reserved • The information on this data sheet was examined carefully and will be accepted as correct; No liability in case of mistakes • Load with extreme values during a longer period can affect the reliability • The material contained herein may not be reproduced, adapted, merged, translated, stored, or used without the prior written consent of the copyright owner • All rights reserved.

